



Looking Southeast from Bond Street



Looking East from Bond Street



Looking Northeast from Bond Street

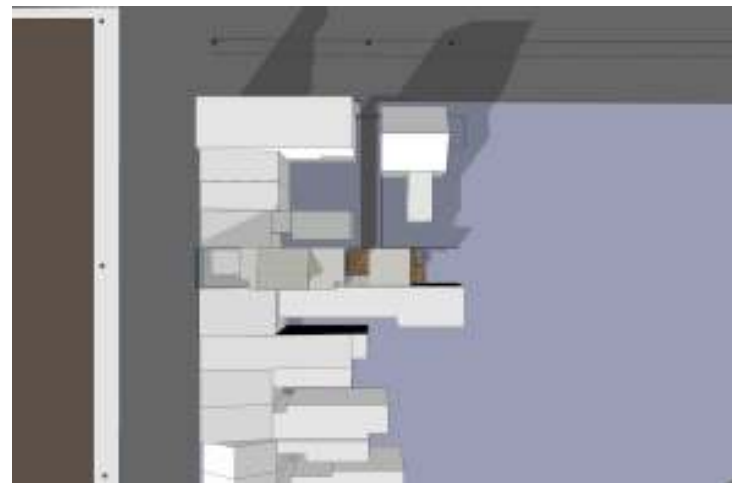

Site Plan

CLIENT: Courtney Klein & Ezra
Hercenberg
PROJECT: 825 S. Bond St.
Baltimore, MD 21231
DATE: 06.18.2013

CHAP Submission
Fells Point Historic District

trace **A-8**
ARCHITECTS

338 E. 25TH ST, SUITE 100
BALTIMORE, MD 21218
(P) 443 838 0379
www.tracearchitects.com jim@tracearchitects.com